

Rev.	Modify	Date	Signed	Approved
Rev.	Modify	Date	Signed	Approved
Rev.	Modify	Date	Signed	Approved

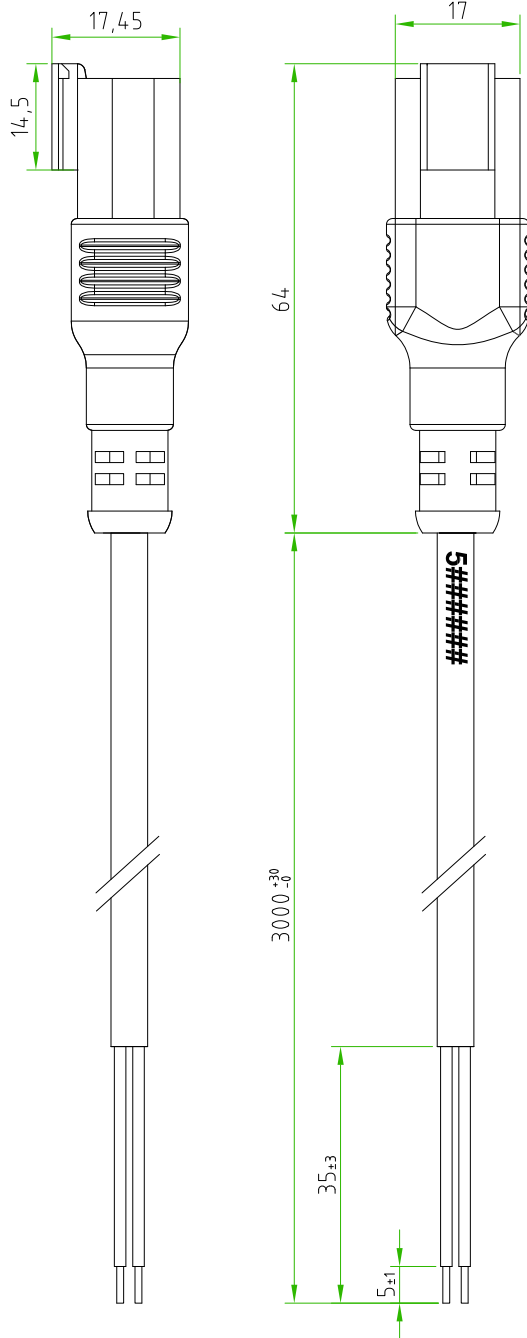

BROWN ○ ———— ■ 1  
BLUE ○ ———— ■ 2

CONNECTOR FEATURES	PRODUCT TYPE	AUTOMOTIVE CONNECTOR (INTERCHANGEABLE WITH DEUTSCH CONNECTOR DT04 SERIES)
	AUTOMOTIVE CONNECTOR TYPE	STRAIGHT 180° MALE 2 POLES
	NUMBER OF CONTACTS CONNECTED	N°2
	CONNECTOR COLOUR	BLACK
	CIRCUIT TYPE	WITHOUT ELECTRONIC
	RATED VOLTAGE	250V AC/300V DC
CABLE FEATURES	CONNECTOR WITHOUT ANY LOGO	
	H.T.P.CABLE CODE	CAVO A2
	NUMBER OF CONDUCTORS	N°2
	CONDUCTORS SECTION	0,75mm <sup>2</sup>
	CABLE MATERIAL	PVC IEC332-1 H05VVF
	COATING COLOUR	BLACK
	CONDUCTORS INSULATION MATERIAL	PVC
	CABLE LENGTH	3000mm
	STRIPPING	35mm STANDARD
	PEELING AND TINNING	5mm STANDARD
	ON THE CABLE, NEAR THE CONNECTOR HEAD, MUST BE SILK PRINTED THE H.T.P. PRODUCTION DATE CODE 5#####	

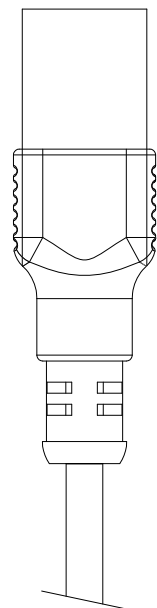

CUSTOMER APPROVAL	
SIGNATURE	DATE
PLEASE SIGN AND RETURN	

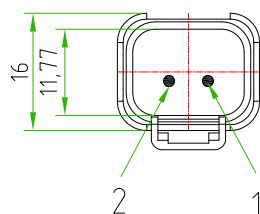

Designer	CIMMINO L.	Date	2021-10-05	Tolerance	±0,3	Units	mm	Series	DEUTCH CONNECTOR	Drawing n. 1-1
Approved	SUGLIANI R.	Date	2021-10-05	Scale	1:1	Size	A4	Customer code:		
<div> <div> </div> <div> </div> </div> <div>DESCRIPTION</div> <div> AUTOMOTIVE CONNECTOR, STRAIGHT 180°, MALE, 2 POLES, BLACK,  WITHOUT ELECTRONIC 250V AC / 300V DC, WITH CABLE PVC/PVC  IEC332-1 H05VVF, 2x0,75mm<sup>2</sup>, BLACK, L=3m CONNECTORS WITHOUT H.T.P. LOGO </div>										<div>H.T.P. PART NUMBER</div> <div>HDCMD2000A23Z</div>

