

Rev.	Modify	Date	Signed	Approved
Rev.	Modify	Date	Signed	Approved
Rev.	Modify	Date	Signed	Approved

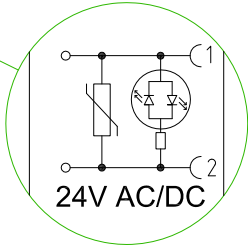

SCALE 3:1

CONNECTOR FEATURES	
PRODUCT TYPE	AUTOMOTIVE CONNECTOR (INTERCHANGEABLE WITH DEUTSCH CONNECTOR DT06 SERIES)
AUTOMOTIVE CONNECTOR TYPE	STRAIGHT 180° FEMALE 2 POLES
NUMBER OF CONTACTS CONNECTED	N°2
CONNECTOR COLOUR	TRASPARENT
CIRCUIT TYPE	BIPOLAR RED LED + VARISTOR
RATED VOLTAGE	24V AC/DC
CONNECTOR WITHOUT ANY LOGO	
CABLE FEATURES	
H.T.P. CABLE CODE	CAVO A9
NUMBER OF CONDUCTORS	N°2
CONDUCTORS SECTION	0,75mm ²
CABLE MATERIAL	PUR Li-YY11Y
COATING COLOUR	BLACK
CONDUCTORS INSULATION MATERIAL	PVC
CABLE LENGHT	6000mm
STRIPPING	35mm STANDARD
PEELING AND TINNING	5mm STANDARD
ON THE CABLE, NEAR THE CONNECTOR HEAD, MUST BE SILK PRINTED THE H.T.P. PRODUCTION DATE CODE 5#####	

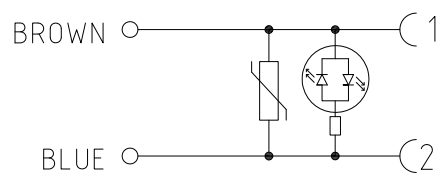
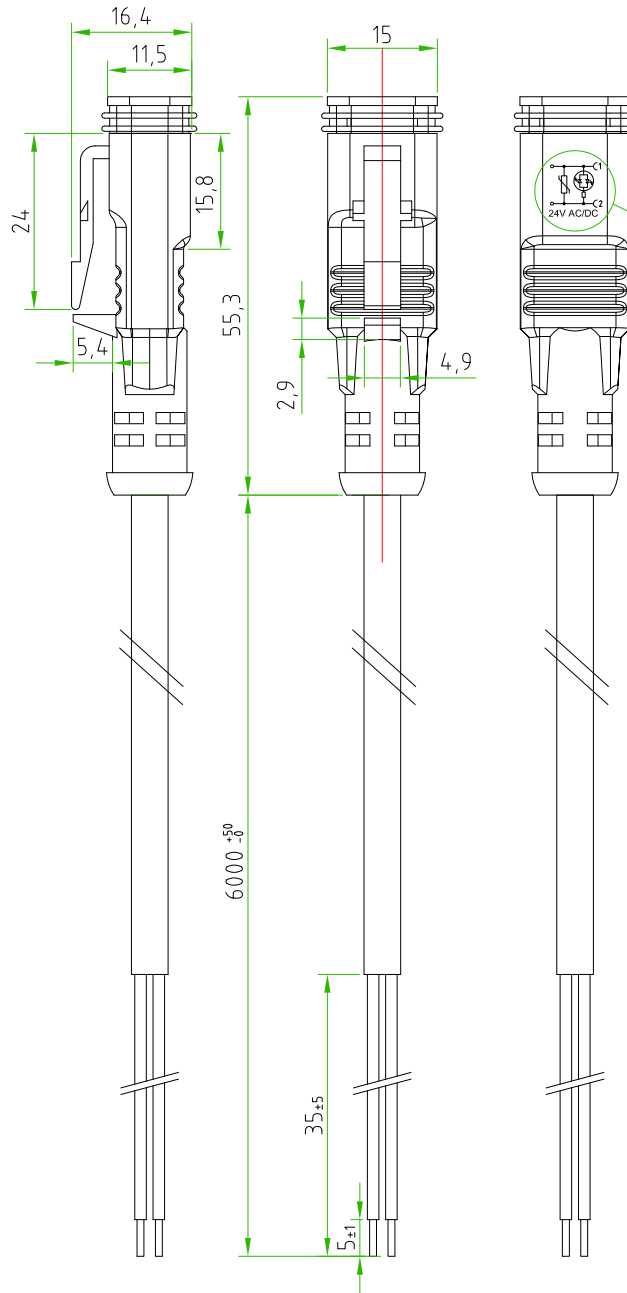
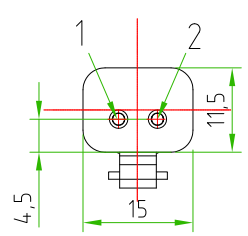

CUSTOMER APPROVAL

SIGNATURE	DATE

PLEASE SIGN AND RETURN

A4

Designer	SUGLIANI R.	Date	2019-06-05	Tolerance	±0,3	Units	mm	Series	DEUTCH CONNECTOR	Drawing n. 1-1
Approved	CIMMINO L.	Date	2019-06-05	Scale	1:1	Size	A4	Customer code:		



DESCRIPTION
AUTOMOTIVE CONNECTOR, STRAIGHT 180°, FEMALE, 2 POLES, TRASPARENT, WITH BIPOLAR RED LED + VARISTOR, 24V, WITH CABLE PUR/PVC, Li-YY11Y, 3G0.75mm², BLACK, L=6m. CONNECTOR WITHOUT H.T.P. LOGO

H.T.P. PART NUMBER
HDCFD2VL1A96Z