

Rev.	Modify	Date	Signed	Approved

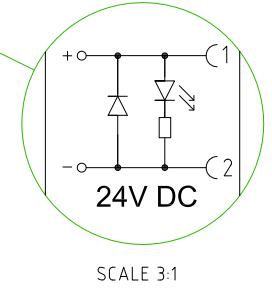

CONNECTOR FEATURES	
PRODUCT TYPE	AUTOMOTIVE CONNECTOR (INTERCHANGEABLE WITH DEUTSCH CONNECTOR DT06 SERIES)
AUTOMOTIVE CONNECTOR TYPE	STRAIGHT 180° FEMALE 2 POLES
NUMBER OF CONTACTS CONNECTED	N°2
CONNECTOR COLOUR	TRASPARENT
CIRCUIT TYPE	RED LED + DIODE (1A)
RATED VOLTAGE	24V DC
CONNECTOR WITHOUT ANY LOGO	
CABLE FEATURES	
H.T.P.CABLE CODE	CAVO A2
NUMBER OF CONDUCTORS	N°2
CONDUCTORS SECTION	0,75mm <sup>2</sup>
CABLE MATERIAL	PVC IEC332-1 H05VVF
COATING COLOUR	BLACK
CONDUCTORS INSULATION MATERIAL	PVC
CABLE LENGTH	1000mm
STRIPPING	35mm STANDARD
PEELING AND TINNING	5mm STANDARD
ON THE CABLE, NEAR THE CONNECTOR HEAD, MUST BE SILK PRINTED THE H.T.P. PRODUCTION DATE CODE 5#####	

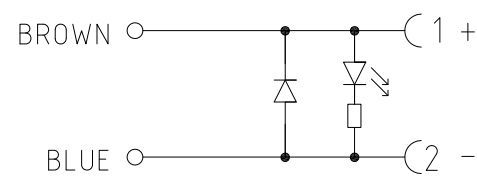
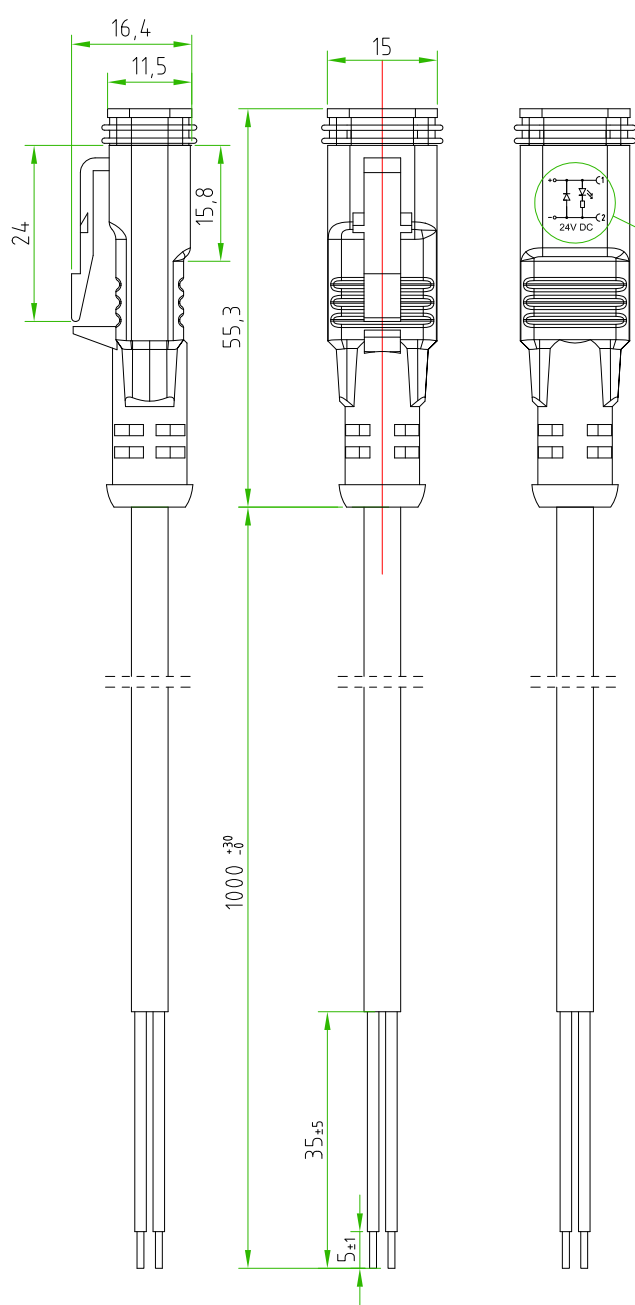
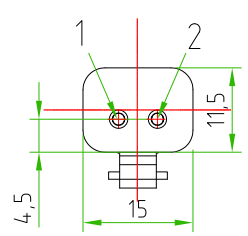

CUSTOMER APPROVAL	
SIGNATURE	DATE
PLEASE SIGN AND RETURN	

Designer	CIMMINO L.	Date	2021-05-11	Tolerance	±0,3	Units	mm	Series	DEUTCH CONNECTOR	Drawing n. 1-1
Approved	SUGLIANI R.	Date	2021-05-11	Scale	1:1	Size	A4	Customer code:		

	<b>DESCRIPTION</b>
	AUTOMOTIVE CONNECTOR, STRAIGHT 180°, FEMALE, 2 POLES, TRASPARENT, WITH DIODE (1A) + RED LED, 24V DC, WITH CABLE PVC/PVC, 2x0,75mm <sup>2</sup> IEC332-1 H05VVF, BLACK, L=1m. CONNECTOR WITHOUT H.T.P. LOGO

<b>H.T.P. PART NUMBER</b>
HDCFD2DL1A21Z

