

Rev.	Modify	Date	Firma	Approved

Rev.	Modify	Date	Firma	Approved

Rev.	Modify	Date	Signed	Approved
01	-	2017-02-15	SUGLIANI	CIMMINO

A4

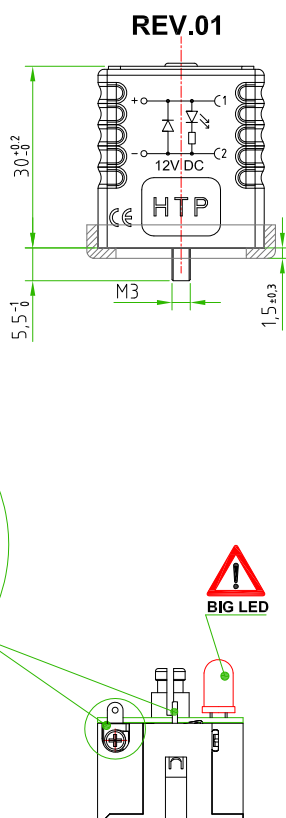
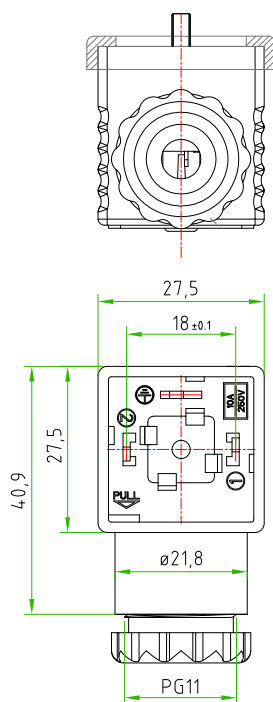
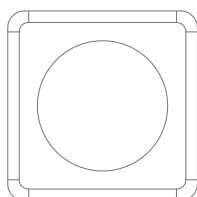
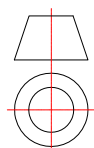

**! PAY ATTENTION:**  
MUST BE USED SPRING CONTACTS

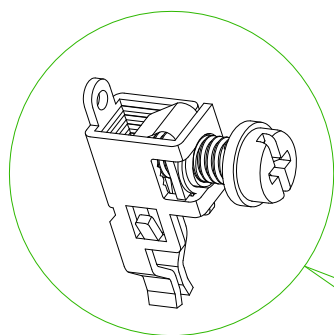

**! BIG LED**

CUSTOMER APPROVAL	
SIGNATURE	DATE
PLEASE SIGN AND RETURN	

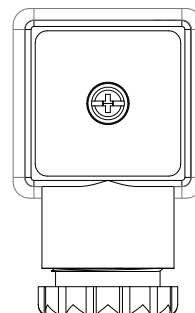
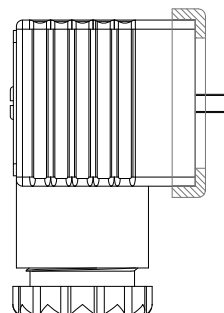
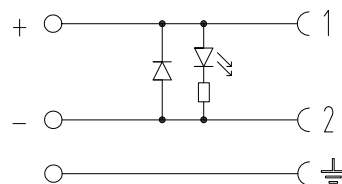

CONNECTOR FEATURES	PRODUCT TYPE	EN175301-803 FORM A FIELD ATTACHABLE.
	HOUSING MATERIAL/COLOUR	PA66 /TRANSPARENT
	PRESS-CABLE MATERIAL/COLOUR	PA66 /BLACK
	INTRENAL CORE MATERIAL/COLOUR	PA66 /BLACK
	HEIGHT HOUSING	30mm
	CONTACTS SPACING	18mm
	CONTACTS TYPE	SCREW CONTACTS(with protection plate)
	NUMBER OF POLES	2POLES+EARTH
	EARTH POSITIONING	H.12 (TURNABLE)
	CABLE EXIT	PG9/11 UNIFIED
	SUITABLE CABLE	FROM ø6mm TO ø10mm
	MAX.CONDUCTOR SIZE	1,5mm <sup>2</sup>
	PROTECTION CLASS	IP67
	CIRCUIT TYPE	BIG RED LED+DIODE (1A)
	RATED VOLTAGE	12V DC
CONNECTOR WITH H.T.P. LOGO		
<b>! -BL means BIG LED = this product is special because the LED is bigger than the standard: the diameter is about ~5,00mm and it's ~8,75mm high</b>		

Designer	SUGLIANI R.	Date	2016-11-21	Tolerance	±0,2	Units	mm	Series	EN175301-803 (form A)	Drawing n. 1/1
Approved	CIMMINO L.	Date	2016-11-21	Scale	1:1	Size	A4	Customer code:		
<b>DESCRIPTION</b> SQUARE CONNECTOR EN175301-803 FORM A, FIELD ATTACHABLE, 2P.+PE, WITH BIG RED LED+DIODE (1A), 12V DC, TRANSPARENT HOUSING, PG9/11 unified. CONNECTOR WITH H.T.P. LOGO.										<b>H.T.P.PART NUMBER</b>  G1TU2DL4-BL