

Rev.	Modify	Date	Signed	Approved
Rev.	Modify	Date	Signed	Approved
Rev.	Modify	Date	Signed	Approved
Rev.	Modify	Date	Signed	Approved

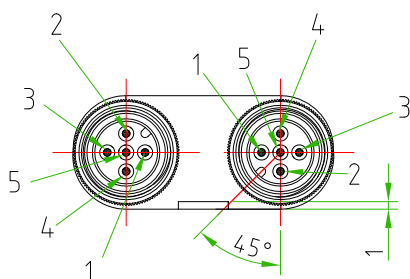

CUSTOMER APPROVAL	
SIGNATURE	DATE
PLEASE SIGN AND RETURN	

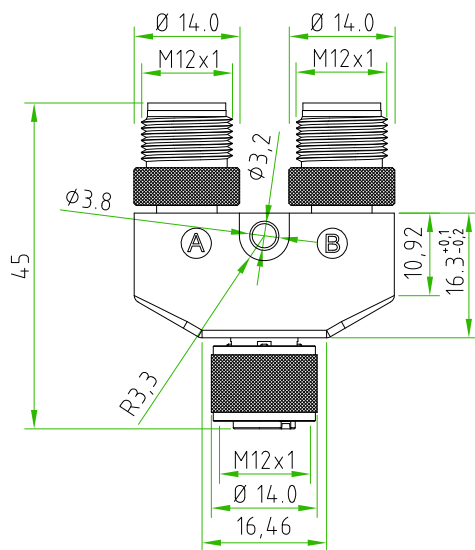
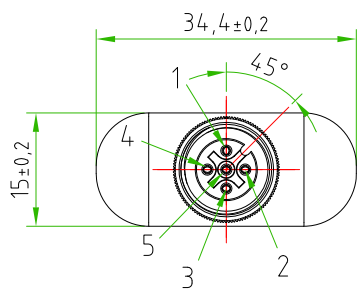
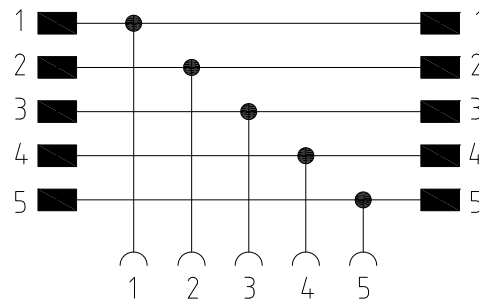

CIRCUIT SILK PRINTED
SCALE 2:1

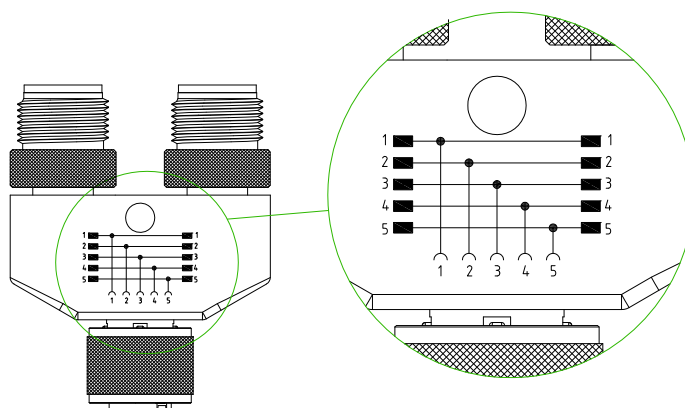

CONNECTOR FEATURES	PRODUCT TYPE	M12 T CIRCULAR CONNECTOR
	CONTACTS TYPE	SIDE A: MALE 5POLES SIDE B: MALE 5POLES INPUT: FEMALE 5POLES (5HOLES)
	NUMBER OF CONTACTS CONNECTED	N°5
	HOUSING MATERIAL	POLYPROPYLENE
	COLOUR	BLACK
	CONTACTS MATERIAL	GOLD PLATED
	COUPLING NUT MATERIAL	BRASS+NICKEL PLATED
	CIRCUIT TYPE	PARALLEL
	RATED VOLTAGE	60V AC/DC
	RATED CURRENT	4A
	FIXING HOLE DIAMETER	Ø3,2mm
	PRODUCT WITHOUT H.T.P.LOGO	
	 PAY ATTENTION TO ALL THE POLARIZATION KEYS POSITIONING OF EACH CONNECTOR.	

A4

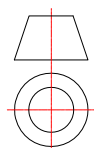

Designer	SUGLIANI R.	Date	2017-02-03	Tolerance	±0.3	Units:	mm	Series	M12 T	Drawing n. 1-1
Approved	CIMMINO L.	Date	2017-02-03	Scale	TO FIT	Size:	A4	Customer code:		



DESCRIPTION

M12 T CONNECTOR, SIDE A:MALE,5POLES ;SIDE B:MALE 5POLES
INPUT:FEMALE 5POLES(5HOLES) , BLACK COLOUR,T CONNECTOR
WITHOUT H.T.P.LOGO.

H.T.P.PART NUMBER

12T36000-B-JB