

Rev.	Modify	Date	Signed	Approved

Rev.	Modify	Date	Signed	Approved

Rev.	Modify	Date	Signed	Approved

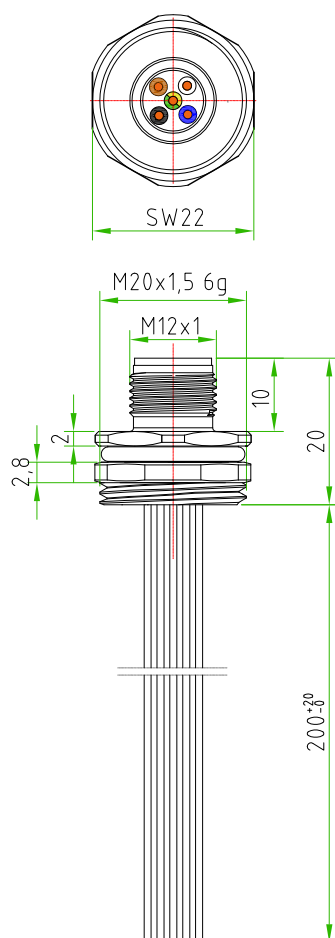

BROWN ○ ———— ■ 1
 WHITE ○ ———— ■ 2
 BLUE ○ ———— ■ 3
 BLACK ○ ———— ■ 4
 YELLOW/GREEN ○ ———— ■ 5

CONNECTOR FEATURES	PRODUCT TYPE	M12 CIRCULAR CONNECTOR TO PANEL WITH WIRES
	TYPE MOUNTING	FRONTAL MOUNTING
	CONTACTS TYPE	MALE 5POLES
	NUMBER OF CONTACTS CONNECTED	N°5
	HOUSING MATERIAL	BRASS+NICKEL PLATED
	O-RING MATERIAL	NBR
	FIXING THREAD	M20X1,5
	SIZE FIXED NUT(SW)	SW22
	SIZE MOBILE NUT(SW)	SW22
	PROTECTION CLASS	IP67
	RATED VOLTAGE	60V AC/DC
	RATED CURRENT	4A
WIRES FEATURES	CONNECTOR WITHOUT ANY LOGO	
	NUMBER OF CONDUCTORS	N°5
	CONDUCTORS SECTION	0,75mm ²
	CONDUCTORS INSULATION MATERIAL	PVC
	CONDUCTORS LENGHT	200mm

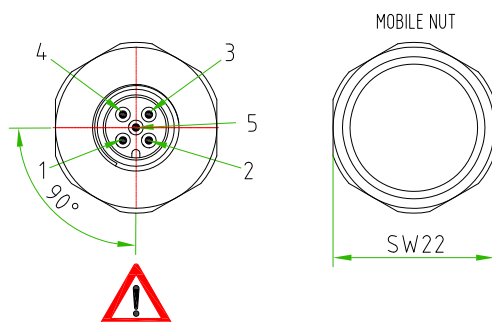

PAY ATTENTION to the position of the polarization key towards the exagonal fixing nut.

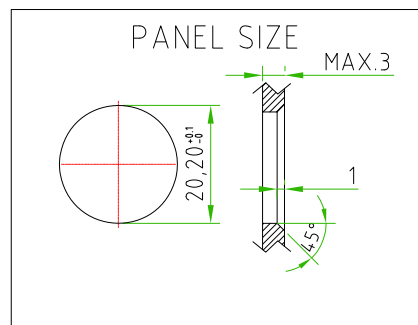

CUSTOMER APPROVAL

SIGNATURE

DATE

PLEASE SIGN
AND RETURN

Designer	SUGLIANI R.	Date	2016-09-01	Tolerance	±0.3	Units:	mm	Series	M12	Drawing n. 1-1
Approved	CIMMINO L.	Date	2016-09-01	Scale	1:1	Size:	A4	Customer code:		



DESCRIPTION

CIRCULAR CONNECTOR M12, MALE, TO PANEL, 5POLES, FRONTAL MOUNTING, M20X1,5 FIXING THREAD, WITH N°5 WIRES PVC 0,75mm² L=200mm
 CONNECTOR WITHOUT ANY LOGO

H.T.P. PART NUMBER

12MP520B-M20

A4

