

DATE	REV.	DESCRIPTION	NAME
16/10/2020	01	ADDED INFORMATION IN THE TABLE OF THE DRAWING	ROBERTO SUGLIANI
30/04/2021	02	CHANGED INTERNAL CORE LENGTH TO 15,4mm AND ADDED CUT ON THE BOTTOM SIDE	ROBERTO SUGLIANI

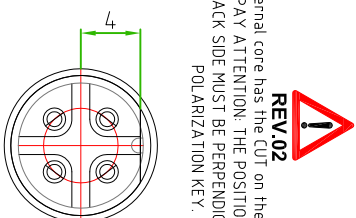

This internal core has the CUT on the your back side.
PLEASE PAY ATTENTION: THE POSITION OF THE CUT OF
THE BACK SIDE MUST BE PERPENDICULAR TO THE
POLARIZATION KEY.

CONNECTOR FEATURES	
CONNECTOR TYPE REV.01	M12 INTERNAL CORE 180° STANDARD (IEC-61076-2-101)
INTERNAL CORE TYPE	MALE
INTERNAL CORE MATERIAL	PA66
COLOUR	GREY
O-RING MATERIAL	NBR
NUMBER OF CONTACTS	N°4
CONTACT MATERIAL REV.01	BRASS + GOLD FLASHING
CONTACT RESISTANCE	REV.01 max 10mΩ
MECHANICAL LIFE CYCLE	N°100 (GOLD FLASHING) REV.01
INSULATION RESISTANCE	REV.01 min 100MΩ
RATED VOLTAGE	250V AC/DC
RATED CURRENT	4A
CONNECTOR WITHOUT H.T.P. LOGO	

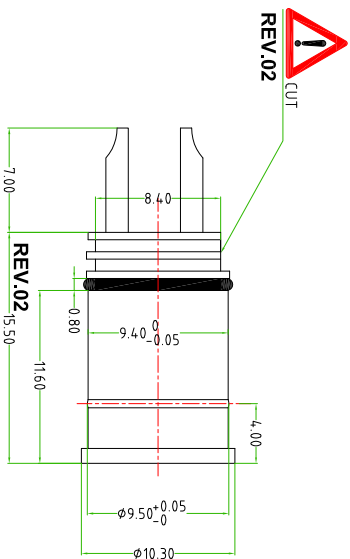
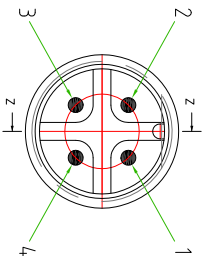
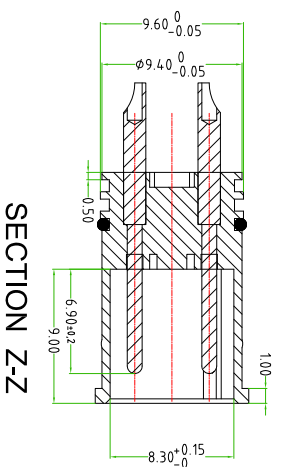

SECTION Z-Z

TOLLERANZE	DISIGNAZIONE	DATA	SCALA	DESIGN N.
UDM	±0.2 ANGOLO CONTROLLATO	05/12/12	2:1	
DESCRIZIONE	M12 INTERNAL CORE MALE 4POLES, COLOUR GREY, WITH SOLDERED CONTACTS.		TIPO	M12
			CODE	12MN4000-G
H.T.P. HIGH TECH PRODUCTS				