

- BROWN ○ ————— C 1
- BLUE ○ ————— C 2
- WHITE ○ ————— C 3
- GREEN ○ ————— C 4
- PINK ○ ————— C 5
- YELLOW ○ ————— C 6
- BLACK ○ ————— C 7
- GREY ○ ————— C 8
- RED ○ ————— C 9
- VIOLET ○ ————— C 10
- GREY - PINK ○ ————— C 11
- RED-BLUE ○ ————— C 12

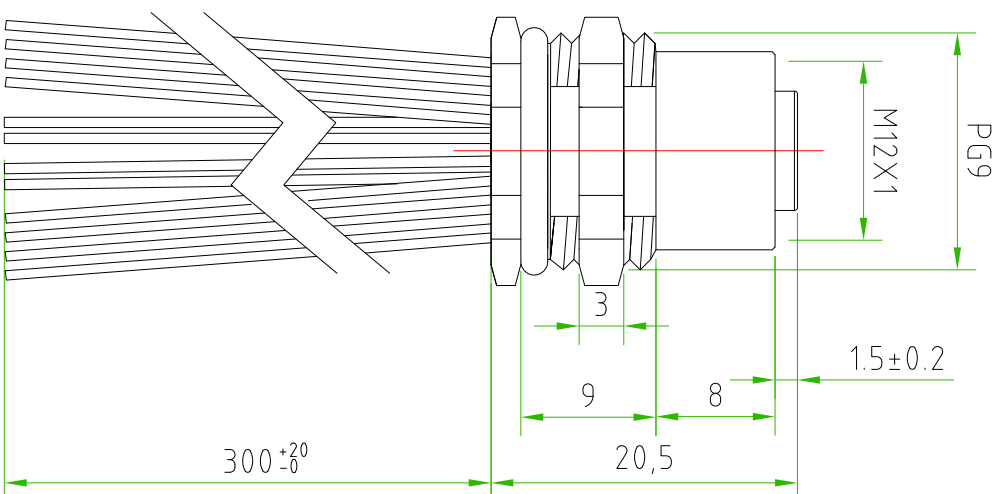

PAY ATTENTION to the CUT of the thread and the positioning of the internal core

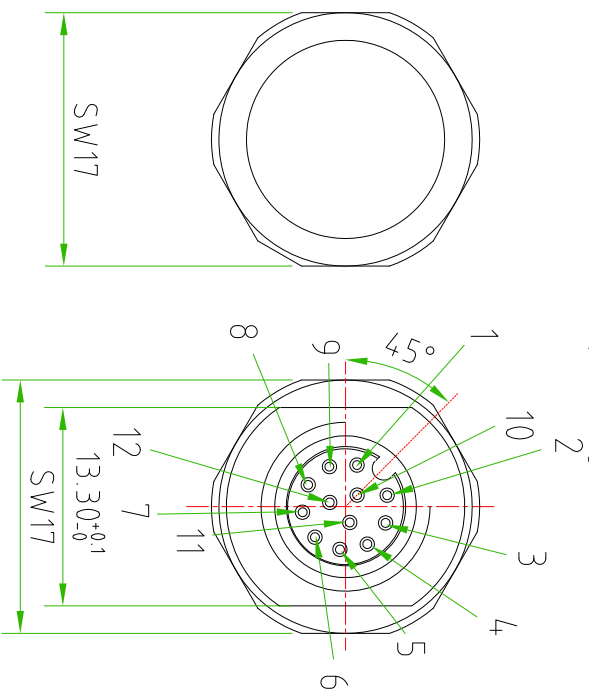

CONNECTOR FEATURES	
CONNECTOR TYPE	M12 TO PANEL
MOUNTING TYPE	BACK
CONTACT TYPE	FEMALE
NUMBER OF CONTACTS CONNECTED	n°12
HOUSING MATERIAL	Brass+nickel plated (CuZnNi)
FIXING THREAD	PG9
SWITCH FIXED NUT	SW17
CONTACT TYPE	SOLDERED CONTACTS
SIZE CUT	13.3mm -0/+0.1
CONDUCTOR MATERIAL	PVC
CONDUCTOR LENGHT	300mm
CONDUCTOR SECTION	0.14mm ²
n°OF CONDUCTORS	12
RATED VOLTAGE	30V AC/DC
RATED CURRENT	1,5A
CONNECTOR WITHOUT H.T.P.LOGO	

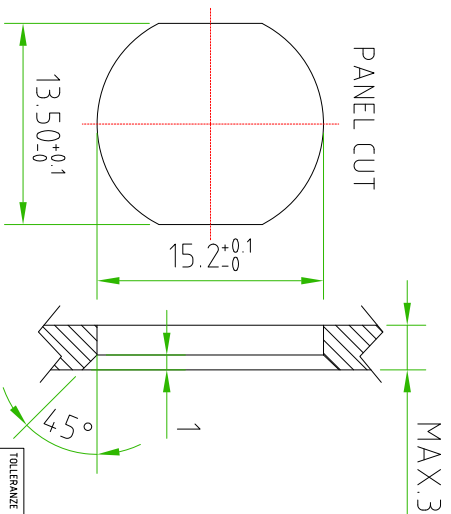

TOLLERANCE		±0.2	DESIGN CODE			DESIGN N.
U&H	ANGOLO	CONTRALLATO	DATA	SCALA		
			26.08.13	2:1		
DESCRIPTION 12 FEMALE PANEL 12 POLES BACK MOUNTING PG9 WITH SOLDERED CONTACTS, WITH CUT ON THE THREAD PG9 N°12WIRES 0,14mm² L=300mm				TIPO	MATERIALE	
				M12		
				CODE	12FR12K0C-PG9-CUT	
High Tech Products						
H.T.P.						
HIGH TECH PRODUCTS						