

Rev.	Modify	Date	Signed	Approved

Rev.	Modify	Date	Signed	Approved

Rev.	Modify	Date	Signed	Approved

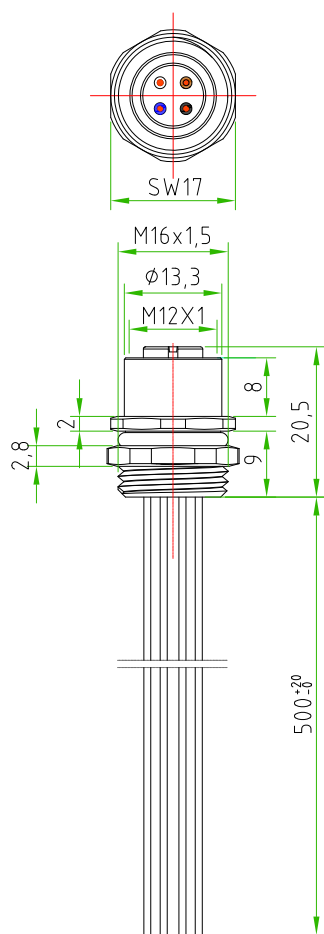

BROWN ○ ————— C 1
 WHITE ○ ————— C 2
 BLUE ○ ————— C 3
 BLACK ○ ————— C 4

CONNECTOR FEATURES	PRODUCT TYPE	M12 CIRCULAR CONNECTOR TO PANEL WITH WIRES.
	TYPE MOUNTING	FRONTAL MOUNTING
	CONTACTS TYPE	FEMALE 4POLES
	NUMBER OF CONTACTS CONNECTED	N°4
	HOUSING MATERIAL	BRASS+NICKEL PLATED
	O-RING MATERIAL	NBR
	FIXING THREAD	M16x1,5
	SIZE FIXED NUT(SW)	SW17
	SIZE MOBILE NUT(SW)	SW17
	PROTECTION CLASS	IP67
	RATED VOLTAGE	250V AC/DC
	RATED CURRENT	4A
WIRES FEATURES	CONNECTOR WITHOUT ANY LOGO	
	NUMBER OF CONDUCTORS	N°4
	CONDUCTORS SECTION	0,34mm ²
	CONDUCTORS INSULATION MATERIAL	PVC
	CONDUCTORS LENGHT	500mm

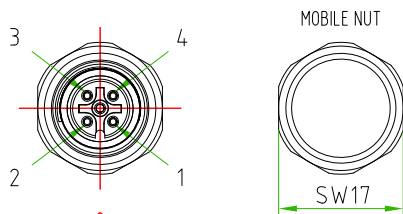

PAY ATTENTION to the position of the polarization key towards the exagonal fixing nut.

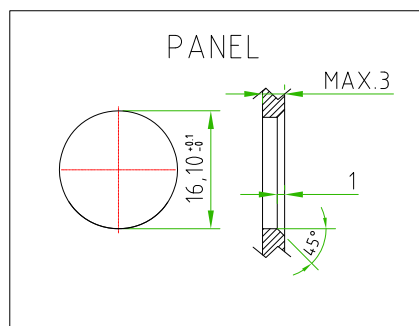

CUSTOMER APPROVAL

SIGNATURE

DATE

PLEASE SIGN
AND RETURN

A4

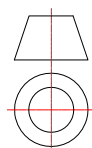

DESCRIPTION

CIRCULAR CONNECTOR M12,FEMALE,TO PANEL,4POLES,FRONTAL MOUNTING, M16x1,5 THREAD,WITH N°4 WIRES PVC 0,34mm² L=500mm . CONNECTOR WITHOUT ANY LOGO

H.T.P.PART NUMBER

12FP4B0E-M16